

WOOD & LINK FENCE CO.

WA.ST.CONT.ID# WOODLLF89418

BID DATE 6-30-24

PO BOX 2505 YELM, WA 98597

PRICE \$ 7770-

360-280-4996

TAX \$ 738.15 TAX RATE % 9.5

CUSTOMER Nisqually Meadows HOA TOTAL \$ 8508.15

ADDRESS 15007 105th Ave SE JOB LOCATION _____

CITY Yelm ZIP 98597 lot 'c'

PHONE Justin _____

HOA@nisquallymeadowshoa.com SPECIFICATIONS DIAGRAM

OVERALL FOOTAGE <u>111'</u>	POSTS:
HEIGHT <u>8'</u>	<u>PRESS TREATED</u>
GUAGE <u>Cedar</u>	<u>GALVANIZED</u>
LINE POST <u>4x4 PT</u>	<u>COLORED</u>
TERM POST <u>4x4 PT</u>	<u>SET IN CONCRETE</u>
WALK GATE	GALV FAERIC
VEHICLE GATE	VINYL FAERIC
SLIDER SINGLE	**NOTES**
SWING DOUBLE	
WALK GATE POST	
DRIVE GATE POST	
GATE FRAME	
TOP RAIL <u>5 2x4 PF - three rails</u>	
TENSION WIRE	
FENCE TO FOLLOW	
GROUND CONTOUR <u>x</u>	
STRAIGHT ON TOP <u>x</u>	
LINES TO BE CLEARED BY CUSTOMER	
LINES TO BE CLEARED BY CONTRACTOR <u>x</u>	

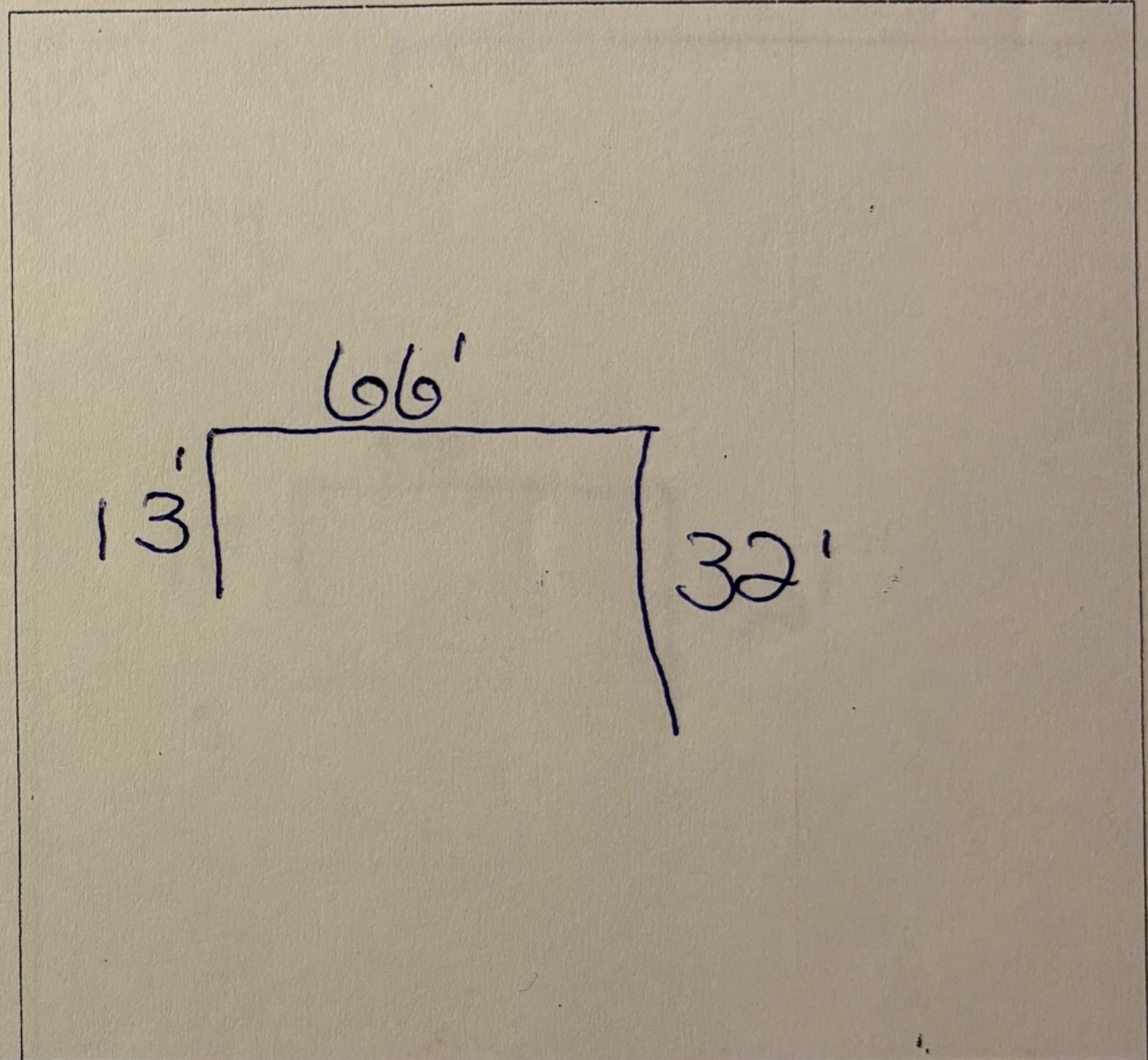

CUSTOMER HEREBY ASSUMES FULL RESPONSIBILITY FOR THE LOCATION OF THE LINE UPON WHICH SAID FENCE IS TO BE INSTALLED AND AGREES TO BE RESPONSIBLE FOR ALL ADDITIONAL LABOR AND/OR MATERIAL NECESSARY TO REMOVE AND/OR RELOCATE AND ANY PERMITS THAT MAY BE REQUIRED. ANY ADDITIONAL TRIPS, MATERIAL OR LABOR DUE TO CHANGES IN THE JOB PLAN PER CUSTOMERS REQUEST WILL BE SUBJECT TO ADDITIONAL CHARGES.

WE HEREBY PROPOSE TO FURNISH MATERIAL AND LABOR - COMPLETE IN ACCORDANCE WITH ABOVE SPECIFICATIONS. THIS SALE IS FOR "CASH ON COMPLETION" UNLESS OTHERWISE ARRANGED. IN THE EVENT THAT PURCHASER FAILS TO PAY WHEN DUE ANY AMOUNT OWED UNDER THIS CONTRACT, PURCHASER AGREES TO PAY DELIQUENCY CHARGE OF 1.5% PER MONTH ON UNPAID BALANCE AND ANY ATTORNEY AND/OR COLLECTION FEES.

THE PARTIES FURTHER AGREE THAT IN ADDITION TO ANY OTHER RIGHTS THAT THE SELLER MAY HAVE AND WITHOUT PREJUDICE TO THE SAME, THAT SELLER MAY CLAIM A LIEN ON THE PREMISES UPON WHICH THE WITHIN MATERIAL AND SUPPLIES ARE TO BE INSTALLED FOR SAID MATERIALS AND SUPPLIES AND THAT PURCHASER WAIVES NOTICE OF SAME.

THIS PROPOSAL MAY BE WITHDRAWN BY US IF

CONTRACTORS SIGNATURE [Signature]

NOT ACCEPTED WITHIN 30 DAYS.

CUSTOMERS SIGNATURE _____

WOOD & LINK FENCE CO.

WA.ST.CONT.ID# WOODLLF894L8

BID DATE 6-30-24

PO BOX 2505 YELM, WA 98597

PRICE \$ 6660-

360-280-4996

TAX \$ 632.70 TAX RATE % 9.5

CUSTOMER Disqually Meadows HOA TOTAL \$ 7292.70

ADDRESS 15007 105th Ave SE

JOB LOCATION

CITY Yelm ZIP 98597

lot 'C'

PHONE [REDACTED]

HOA Disquallymeadowshoa.com SPECIFICATIONS DIAGRAM

OVERALL FOOTAGE	<u>111'</u>	POSTS:
HEIGHT	<u>6'</u>	PRESS TREATED
GAUGE	<u>Cedar</u>	GALVANIZED
LINE POST	<u>4x4 PT</u>	COLORED
TERM POST	<u>4x4 PT</u>	SET IN CONCRETE
WALK GATE		GALV FAERIC
VEHICLE GATE		VINYL FAERIC
SLIDER	<u>SINGLE</u>	**NOTES**
SWING	<u>DOUBLE</u>	
WALK GATE POST		
DRIVE GATE POST		
GATE FRAME		
TOP RAIL	<u>3 2x4 DF - three rails</u>	
TENSION WIRE		
FENCE TO FOLLOW		
GROUND CONTOUR	<u>X</u>	
STRAIGHT ON TOP	<u>X</u>	
LINES TO BE CLEARED BY CUSTOMER		
LINES TO BE CLEARED BY CONTRACTOR	<u>X</u>	

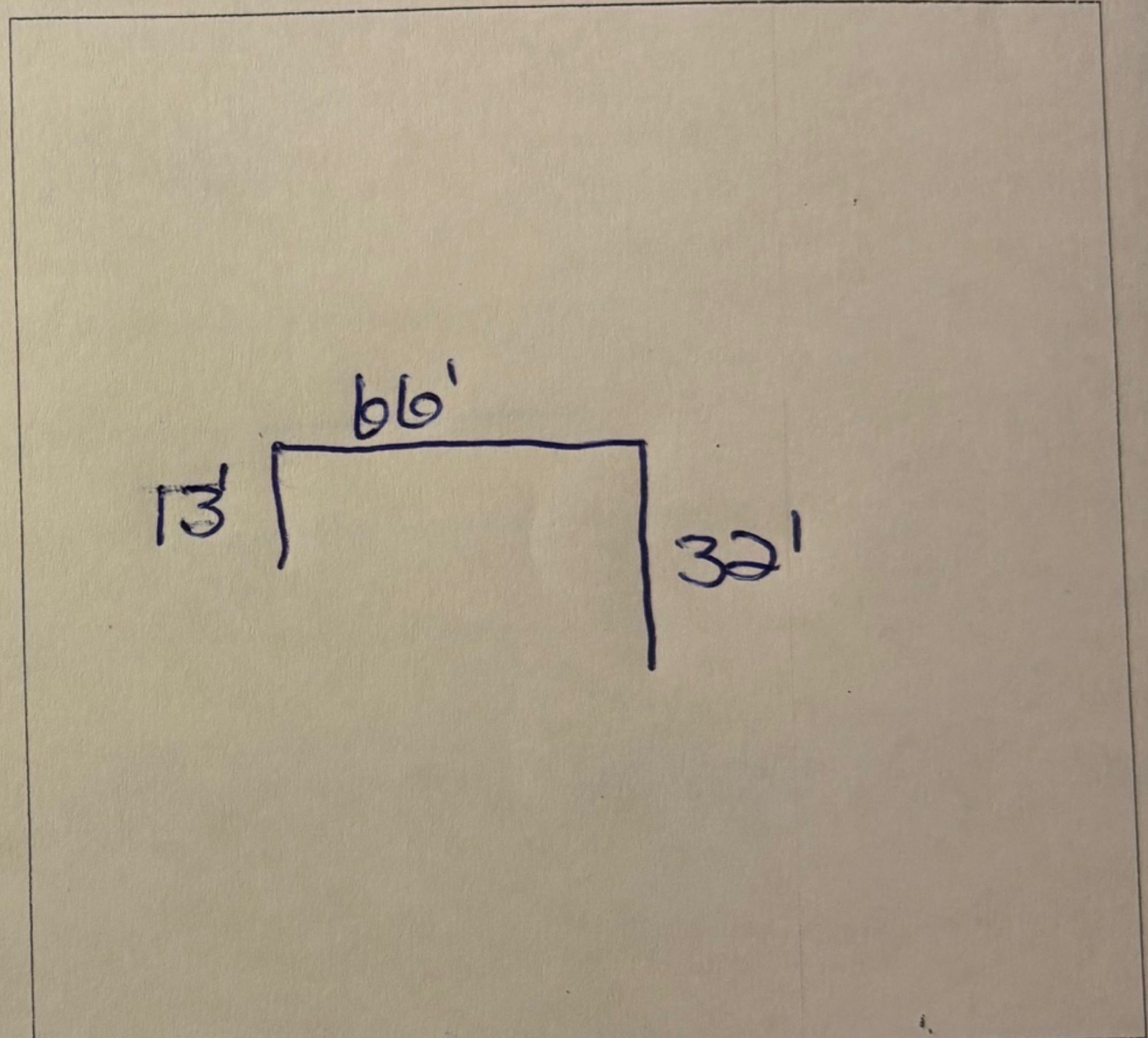

CUSTOMER HEREBY ASSUMES FULL RESPONSIBILITY FOR THE LOCATION OF THE LINE UPON WHICH SAID FENCE IS TO BE INSTALLED AND AGREES TO BE RESPONSIBLE FOR ALL ADDITIONAL LABOR AND/OR MATERIAL NECESSARY TO REMOVE AND/OR RELOCATE AND ANY PERMITS THAT MAY BE REQUIRED. ANY ADDITIONAL TRIPS, MATERIAL OR LABOR DUE TO CHANGES IN THE JOB PLAN PER CUSTOMERS REQUEST WILL BE SUBJECT TO ADDITIONAL CHARGES.

WE HEREBY PROPOSE TO FURNISH MATERIAL AND LABOR - COMPLETE IN ACCORDANCE WITH ABOVE SPECIFICATIONS. THIS SALE IS FOR "CASH ON COMPLETION" UNLESS OTHERWISE ARRANGED. IN THE EVENT THAT PURCHASER FAILS TO PAY WHEN DUE ANY AMOUNT OWED UNDER THIS CONTRACT, PURCHASER AGREES TO PAY DELIQUENCY CHARGE OF 1.5% PER MONTH ON UNPAID BALANCE AND ANY ATTORNEY AND/OR COLLECTION FEES.

THE PARTIES FURTHER AGREE THAT IN ADDITION TO ANY OTHER RIGHTS THAT THE SELLER MAY HAVE AND WITHOUT PREJUDICE TO THE SAME, THAT SELLER MAY CLAIM A LIEN ON THE PREMISES UPON WHICH THE WITHIN MATERIAL AND SUPPLIES ARE TO BE INSTALLED FOR SAID MATERIALS AND SUPPLIES AND THAT PURCHASER WAIVES NOTICE OF SAME.

THIS PROPOSAL MAY BE WITHDRAWN BY US IF

NOT ACCEPTED WITHIN 30 DAYS.

CONTRACTORS SIGNATURE [Signature]

CUSTOMERS SIGNATURE _____